



Our children deserve the best educational experience possible to prepare them for future personal and professional success and well-being. With this goal in mind, The Foundation at Great Valley was established to unite community resources to enhance and enrich the learning opportunities available to more than 4,000 Great Valley School District students. The Foundation at Great Valley is a newly formed, independent, non-profit, education foundation developed by a dedicated group of volunteer community and business leaders, retired corporate executives and educators.

The Foundation at Great Valley encourages the community to be active participants in student education through philanthropy. By securing funds, resources, and knowledge from the private sector, The Foundation hopes to provide educational, cultural, athletic and wellness initiatives that may not normally be supported by the school district's budget.

The Foundation works in partnership with the Great Valley School District to continue to ensure that students' educational experiences are rich in opportunities, deep in experience, and equal for all, regardless of income. Examples of initiatives supported by the Foundation:

- After school and summer enrichment programs
- Endowments to specific departments or areas of study
- Literacy and tutoring programs to help those with special needs
- Art and Music enrichment
- Innovation in the classroom through teacher grants
- Enhanced support for athletic programs
- Projects that promote cultural diversity
- Communication and Technology initiatives

When our community bridges with our schools, we will be helping our children reach their potential and become stronger citizens in our society. Our future can be influenced through the life of every child.

Learn more about The Foundation at Great Valley. Visit us online at [www.foundationatgreatvalley.org](http://www.foundationatgreatvalley.org)!

**Become a permanent part of  
Great Valley History**



**Honor someone you love,  
commemorate your own experience,  
support your alma mater.**

**The Valley Stadium  
Commemorative  
Brick Project**

The Foundation at Great Valley is pleased to offer you the opportunity to become a permanent part of Great Valley history and to commemorate your experience or the experience of a loved one forever!

With Phase 1 complete, the brick walkway and seating area just outside of Valley Stadium serve as a warm welcome to parents, students, and visitors. Act now! Space is still available to add your name or the name of your loved one.

For your tax-deductible donation, your brick can be engraved with your name, graduating class or personalized message and will be placed in the beautiful arrangement outside of Valley Stadium. The area reminds current families and visitors alike of Great Valley's rich history and community pride. Your name, or the name of someone you love, will become a permanent part of the Great Valley High School campus!

**Purchase your brick today to:**

- Commemorate your experience at GVHS
- Honor a graduate
- Remember a loved one
- Support our schools through a contribution to The Foundation at Great Valley

Please use the enclosed form to select a brick size and to specify wording for your brick. Please use separate forms if you plan to buy more than one brick.

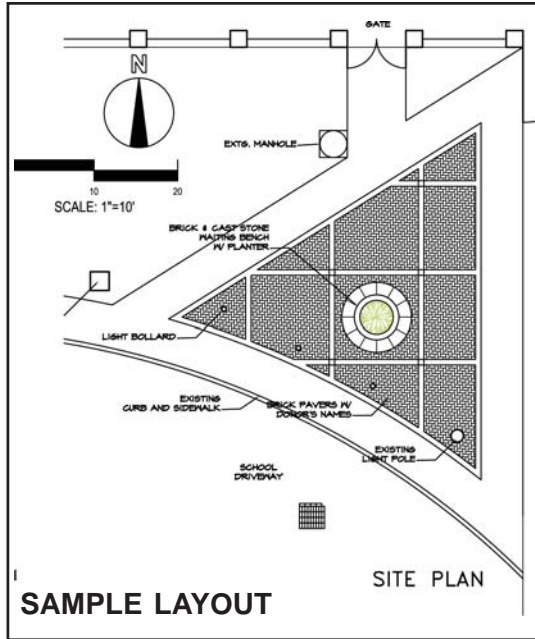

You are invited to become part of the Valley Stadium Commemorative Brick Project. All proceeds will go to The Foundation at Great Valley and will benefit Great Valley School District schools. Your engraved brick will become part of the walkway at the ticket gate, closest to the high school where the football team and band enter.

**Choose from two brick sizes! Or, select to purchase a limestone seat or capstone, the most distinguished of the selections.**

|   |  |
|---|--|
| <p>_____</p> <p>4" x 8" brick</p> <p><b>\$100</b></p>     | <p>up to two lines of lettering, 15 characters per line. Characters include letters, numbers, spaces, and symbols.</p>                                   |
| <p>_____</p> <p>6" x 9" brick</p> <p><b>\$200</b></p>     | <p>up to three lines of lettering, 15 characters per line. Characters include letters, numbers, spaces, and symbols.</p>                                 |
| <p>_____</p> <p>seat or capstone</p> <p><b>\$2500</b></p> | <p>LIMITED NUMBER AVAILABLE</p> <p>up to three lines of lettering, 15 characters per line. Characters include letters, numbers, spaces, and symbols.</p> |

**Examples:**

|                            |                                    |  |  |
|----------------------------|------------------------------------|--|--|
| IN MEMORY<br>MARY SMITH 81 | GO PATRIOTS<br>THE SMITH<br>FAMILY | THE SMITHS<br>MARY 81 JOE 85<br>JOHN 86 JEN 89 | IN MEMORY<br>MARY SMITH<br>CLASS OF 81 |
|----------------------------|------------------------------------|--|--|

**Please fill out one order form for EACH brick.**

LINE 1: 

|  |  |  |  |  |  |  |  |  |  |  |  |  |  |  |  |  |  |  |  |
|--|--|--|--|--|--|--|--|--|--|--|--|--|--|--|--|--|--|--|--|
|  |  |  |  |  |  |  |  |  |  |  |  |  |  |  |  |  |  |  |  |
|--|--|--|--|--|--|--|--|--|--|--|--|--|--|--|--|--|--|--|--|

LINE 2: 

|  |  |  |  |  |  |  |  |  |  |  |  |  |  |  |  |  |  |  |  |
|--|--|--|--|--|--|--|--|--|--|--|--|--|--|--|--|--|--|--|--|
|  |  |  |  |  |  |  |  |  |  |  |  |  |  |  |  |  |  |  |  |
|--|--|--|--|--|--|--|--|--|--|--|--|--|--|--|--|--|--|--|--|

LINE 3: 

|  |  |  |  |  |  |  |  |  |  |  |  |  |  |  |  |  |  |  |  |
|--|--|--|--|--|--|--|--|--|--|--|--|--|--|--|--|--|--|--|--|
|  |  |  |  |  |  |  |  |  |  |  |  |  |  |  |  |  |  |  |  |
|--|--|--|--|--|--|--|--|--|--|--|--|--|--|--|--|--|--|--|--|

**Ordered by:**

Name: \_\_\_\_\_

Address: \_\_\_\_\_

Phone: \_\_\_\_\_ Email: \_\_\_\_\_

Please make checks payable to The Foundation at Great Valley and send to: Brick Project, c/o 47 Church Road, Malvern PA 19355. Payment must be received with order. Please note "Brick" in memo line.